

**Valve Schedule**

	SC	Stopcock
	IV	Isolation Valve
	RV	Regulation Valve
	RVMS	Regulation Valve & Metering Station
	LSV	Lockshield Valve
	NRV	Non Return Valve
	PRV	Pressure Regulation Valve
	EV	Expansion Valve
	PTR	Pressure & Temperature Relief Valve
	ST	Strainer
	DC	Drain Cock
	TVR	Thermostatic radiator valve

**Notes**

- All final connections to sanitary fittings and water outlets provided with inline isolation regulation valves and double check valves where water byelaws require installation.
- For valving arrangements see the diagrammatic drawing, description and schedules in the Operating & Maintenance Instructions.
- Aquaflow regulators used throughout the project to isolate sanitary fittings and control water pressure. All connections 15mm except master bedroom shower and master bedroom bath which are to be 22mm.  
WC Pink 4 litre/sec  
Wash basin White 8 litre/sec  
Wash sink Brown 12 litre/sec
- Under floor heating manifolds have individual actuators controlled by radio controlled room thermostats and isolation valves for each zone.  
Zone 1 - Kitchen Scullery & Breakfast room  
Zone 2 - Dining Room  
Zone 3 - Drawing Room  
Zone 4 - Bedroom 1

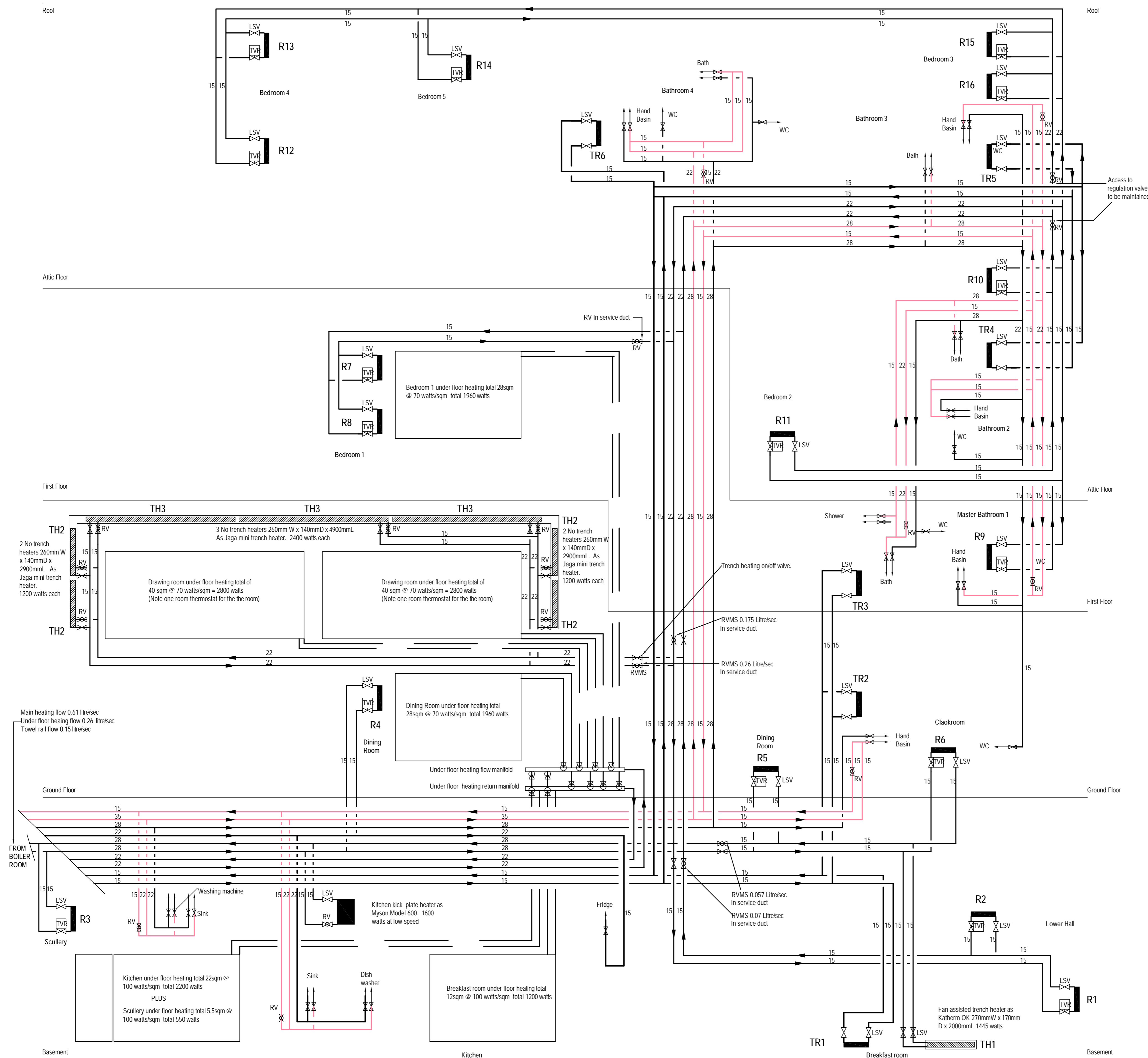

Access to regulation valves to be maintained

Trench heating on/off valve.

RVMS 0.175 Litre/sec In service duct

RVMS 0.26 Litre/sec In service duct

RVMS 0.057 Litre/sec In service duct

RVMS 0.07 Litre/sec In service duct

Main heating flow 0.61 litre/sec  
Under floor heating flow 0.26 litre/sec  
Towel rail flow 0.15 litre/sec

Kitchen under floor heating total 22sqm @ 100 watts/sqm total 2200 watts  
PLUS  
Scullery under floor heating total 5.5sqm @ 100 watts/sqm total 550 watts

Breakfast room under floor heating total 12sqm @ 100 watts/sqm total 1200 watts

Dining Room under floor heating total 28sqm @ 70 watts/sqm total 1960 watts

Drawing room under floor heating total of 40 sqm @ 70 watts/sqm = 2800 watts (Note one room thermostat for the room)

Drawing room under floor heating total of 40 sqm @ 70 watts/sqm = 2800 watts (Note one room thermostat for the room)

Bedroom 1 under floor heating total 28sqm @ 70 watts/sqm total 1960 watts